



**PENTAX OS-A43 WHITE BALANCE  
ADJUSTER**

**SKU: AH042015**

**117,81 €**

zzgl. [Versandkosten](#)

Vollfunktionsfähig  
Im guten gebrauchten Zustand  
Artikel-Standort. Hamburg

www.mtc-hamburg.com  
info@mtc-hamburg.com  
Mobile 0049 176 205 800 86  
Tel / Homezone 0049 40 18 20 79 03  
Tel / Büro 0049 40 3 61 61 - 256  
Fax. 0049 40 3 61 61 - 257



---

Categories: [Endoskopie und Zubehör](#)

## PRODUKTBESCHREIBUNG

Vollfunktionsfähig  
Im guten gebrauchten Zustand  
Artikel-Standort. Hamburg

www.mtc-hamburg.com  
info@mtc-hamburg.com  
Mobile 0049 176 205 800 86  
Tel / Homezone 0049 40 18 20 79 03  
Tel / Büro 0049 40 3 61 61 - 256



Fax.

0049 40 3 61 61 - 257

## ZUSÄTZLICHE INFORMATIONEN



**GALLERIE**

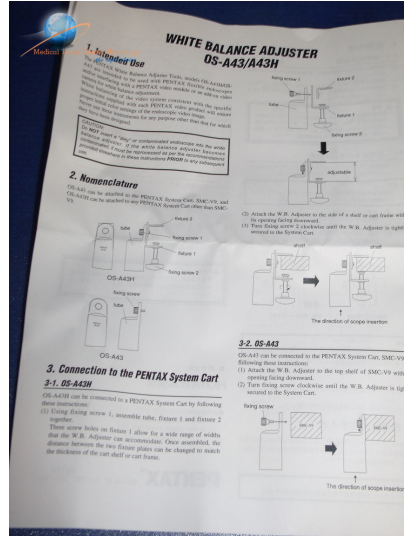

**WHITE BALANCE ADJUSTER  
OS-A43/A43H**

**1. Intended Use**  
The White Balance Adjuster (W.B. Adjuster) OS-A43/A43H is intended for use with PENTAX System Cameras. It is used to adjust the white balance of the camera. The W.B. Adjuster is used to adjust the white balance of the camera. The W.B. Adjuster is used to adjust the white balance of the camera. The W.B. Adjuster is used to adjust the white balance of the camera.

**2. Nomenclature**  
OS-A43 can be attached to OS-PENTAX System Cam. SMC-V9 and OS-A43H can be attached to any PENTAX System Camera lens. OS-A43H can be attached to any PENTAX System Camera lens. OS-A43H can be attached to any PENTAX System Camera lens.



**3. Connection to the PENTAX System Cam**  
**3-1. OS-A43H**  
OS-A43H can be connected to a PENTAX System Cam by following these instructions:  
(1) Loosen the screw 1, unscrew the lens 1 and lens 2 together.  
Then, insert the lens 1 into the W.B. Adjuster as shown in the diagram. Be sure to insert the lens 1 into the W.B. Adjuster as shown in the diagram. Be sure to insert the lens 1 into the W.B. Adjuster as shown in the diagram. Be sure to insert the lens 1 into the W.B. Adjuster as shown in the diagram.

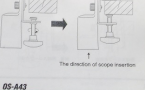
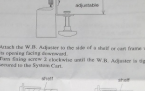
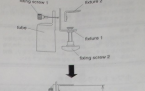

**3-2. OS-A43**  
OS-A43 can be connected to the PENTAX System Cam. SMC-V9 by following these instructions:  
(1) Attach the W.B. Adjuster to the top shelf of SMC-V9 with a spring facing downward.  
(2) Turn the screw clockwise until the W.B. Adjuster is tightly secured to the System Cam.

